

Department of Engineering  
Tim Bryan, P.E., County Engineer

3137 South Liberty Street, Canton, MS 39046  
Office (601) 790-2525 FAX (601) 859-3430

**MEMORANDUM**

February 12, 2021

To: Sheila Jones, Supervisor, District I  
Trey Baxter, Supervisor, District II  
Gerald Steen, Supervisor, District III  
Karl Banks, Supervisor, District IV  
Paul Griffin, Supervisor, District V

From: Tim Bryan, P.E., PTOE  
County Engineer

Re: Cspire Utility Permit  
Project Information: County Road Name, Gluckstadt Road

The Engineering Department recommends approval of permit application for Cspire to access existing hand hole on Gluckstadt Road.

SHEILA JONES  
District One

TREY BAXTER  
District Two

GERALD STEEN  
District Three

KARL BANKS  
District Four

PAUL GRIFFIN  
District Five

Revised: 2/14/2019



### PERMIT APPLICATION FOR THE CONSTRUCTION OR ADJUSTMENT OF A UTILITY WITHIN COUNTY ROAD RIGHT-OF-WAY

**Utility Information:** Utility Name: CSPIRE

Address: 1018 HIGHLAND COLONY PKWY City/State/Zip: RIDGELAND, MS 39157

Contact Person: STEVE CASE Contact's Phone: 662-590-3120

**Project Information:** County Road Name: GLUCKSTADT ROAD  
(If located within more than one road right-of-way, use Appendix 1 for additional descriptions)

Beginning Location: \_\_\_\_\_ Ending Location: \_\_\_\_\_

Length of Project: \_\_\_\_\_ Section: \_\_\_\_\_ Township: \_\_\_\_\_ Range: \_\_\_\_\_

Description of Work: ACCESS EXISTING HAND HOLE ON GLUCKSTADT ROAD

\_\_\_\_\_  
\_\_\_\_\_  
\_\_\_\_\_

Check Box if Appendix 1 is to be included as a part of this Application

Whereas the above stated Utility makes application to the **Madison County Board of Supervisors** for a Construction Permit. Attached hereto are drawings and plans for the construction of the above facilities located within Madison County owned public rights-of-way. Once stamped by the Madison County Engineering Department, these plans shall not be changed or altered without written approval of the County Engineer, or his representative. A copy of the approved permit and plans shall be on-site at all times during construction.

The Applicant Utility shall comply with all policies, procedures and construction practices as outlined in *A Policy for The Accommodation of Utility Facilities within the Right-of-Way of all Public County Roads* (hereinafter referred to as the "Policy"), as adopted on November 1, 2005, by the **Madison County Board of Supervisors**, and which is hereby made a part of this Application Agreement.

If facilities are to be located within the Rights-of-Way of the County-Federal or State Aid System, Applicant Utility also agrees to comply with applicable provisions of *S.O.P. No. SA II-2-8, Accommodation of Utilities on Rights-of-Way*, issued by the State Aid Engineer and dated July 1, 2005.

The Applicant Utility understands and agrees that, except as herein granted, no right, title, claim, or easement to said road right-of-way is granted by the issuance of this permit. If this Utility is listed in the general provisions of the Policy, it will be adjusted to comply with same without cost to the County, unless the variance from the Policy has been approved by the granting of the Permit pursuant to this Application.

The Applicant Utility further understands that the Utility's engineering, plant, or other personnel will be responsible for the staking and construction supervision of the work set out above and as shown on the attached plans. If work impacts traffic in any way, the appropriate traffic control shall be installed per the *Manual of Uniform Traffic Control Devices*, Latest Edition.

The Applicant Utility understands that the County Engineer, or his representative, may issue a Stop Work Order at any time if it is deemed that site conditions are not suitable for construction or if any of the requirements of this permit are not being met.

Many County Roads have variable Rights-of-Way and/or no Right-of-Way at all and are maintained under a Prescriptive Easement. It is the sole responsibility of the Applicant Utility to verify the existence and limits of public rights-of-way. If none exists, it is the

responsibility of the Applicant Utility to acquire an easement for their Facilities from the applicable property owner(s). Madison County in no way verifies the limits of Right-of-Way as shown on the permit application.

The Applicant Utility shall be responsible for all future maintenance and repair of the facilities installed under this permit. The Applicant Utility shall make future adjustments to, or relocate, the facilities located within road or highway right-of-way when required for road or highway widening or other road or highway construction at no cost to Madison County. The Applicant Utility shall relocate said utilities within sixty (60) days of notification by County by registered mail, return receipt requested, unless otherwise designated by the County Engineer. Further, any maintenance, repair, or construction shall be done in such a manner as to occasion no unreasonable interference with the normal flow and safety to traffic and at the expense of the utility company. When reasonable care has been taken to locate said utility facilities within the right-of-way, the Applicant Utility understands that any damages caused by routine maintenance and construction by County forces shall be borne by the Applicant Utility.

The Applicant Utility further agrees to indemnify and hold Madison County harmless for any and all claims, accidents, damages, liabilities and expenses occasioned wholly, or in part, by any act or omission of applicant, its agents or employees. In case County shall, without fault on its own part, be made a party to any litigation commenced by or against applicant, then applicant shall protect and hold County harmless, and shall pay all costs, expenses and reasonable attorney's fees incurred or paid by County in connection with said litigation.

All underground facilities shall be installed at a depth equal to or greater than 48" below the lowest adjacent grade.

All pipes carrying liquid shall be encased under County maintained roads.

WITNESS the signature of the Applicant this the 11<sup>TH</sup> day of FEB, 2021.

By: Steve Carr  
(Applicant Signature)

Title: CONTRACTS & PERMITS

**Note:** Applicant must be an employee of the Utility named in this application. The Madison County Board of Supervisors will not recognize a Contractor, Subcontractor, Agent, or Consulting Engineer as the Applicant. Utility Company shall be fully responsible for all work performed under this application.

I, or my authorized representative, have reviewed this application and determined that the drawing, sketches, and plans submitted by the Applicant meet the requirements of A Policy for The Accommodation of Utility Facilities within the Right-of-Way of all Public County Roads.

**APPROVED**  
By timothy.bryan at 1:29 pm, Feb 24, 2021  
Tim Bryan, P.E.  
County Engineer

AGREED TO AND APPROVED BY:

\_\_\_\_\_  
Madison County Board President

Date: \_\_\_\_\_

ENTERED INTO THE MINUTES OF THE BOARD OF SUPERVISORS OF MADISON COUNTY, MISSISSIPPI ON THIS \_\_\_\_\_ DAY OF \_\_\_\_\_, 20\_\_\_\_.



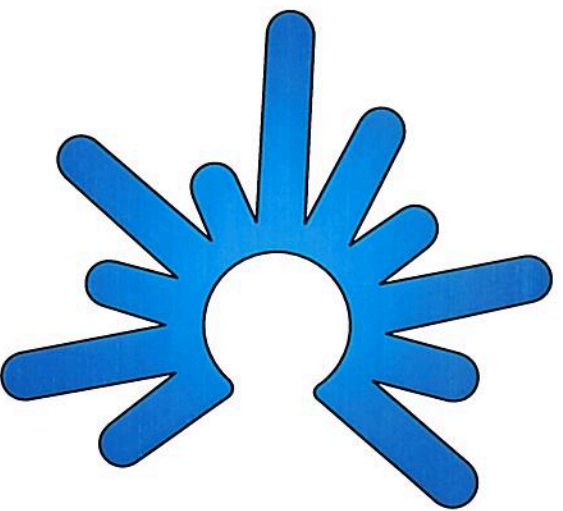

# CSPiRE

## ASBUILT INFORMATION

FIELD ENGINEER: \_\_\_\_\_ NAME: \_\_\_\_\_  
 PROJECT MANAGER: \_\_\_\_\_ NAME: \_\_\_\_\_  
 CONSTRUCTION: \_\_\_\_\_ NAME: \_\_\_\_\_  
 SUB CONTRACTOR: \_\_\_\_\_ NAME: \_\_\_\_\_  
 INSPECTOR: \_\_\_\_\_ PHONE #: \_\_\_\_\_

CONSTRUCTION COMMENCED: \_\_\_\_\_ DATE: \_\_\_\_\_  
 CONSTRUCTION COMPLETED: \_\_\_\_\_ DATE: \_\_\_\_\_  
 FIBER INSTALLED: \_\_\_\_\_ DATE: \_\_\_\_\_  
 FINAL CLEANUP: \_\_\_\_\_ DATE: \_\_\_\_\_

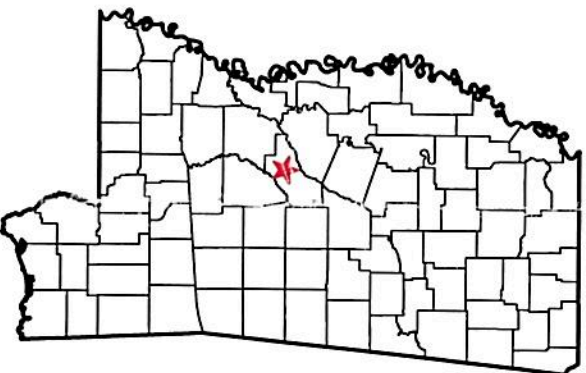

SBI.OSP.62037  
 CS.OSFPMS-MADCTY.MS

<<	PERMITS	>>
CITY : MADISON, MS		

*JB*  
*Not in city*  
*2-1-21*

PROPOSED FIBER BUILD  
 SBI - PARKWAY PENTECOSTAL CHURCH (MADISON)  
 1/19/21



PREPARED BY

43 Town Center Square, Suite 204  
 Hattiesburg, MS 39402  
 Office phone: (601) 402-9149  
 Email: [designservices@bbgeomatics.com](mailto:designservices@bbgeomatics.com)

# ROUTE MAP

PROPOSED CSPIRE FIBER  
EXISTING CSPIRE FIBER

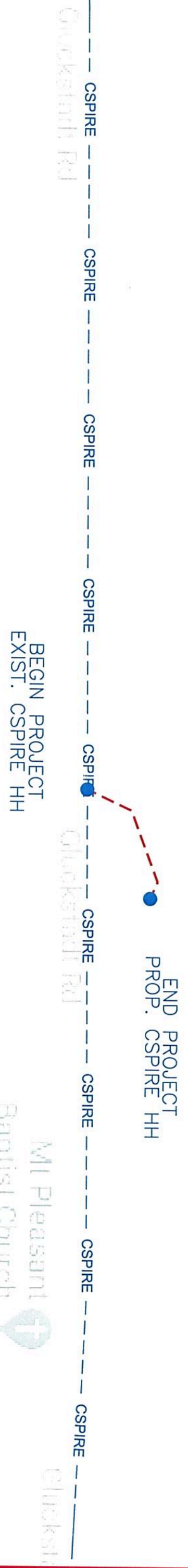

SBI - PARKWAY PENTECOSTAL CHURCH (MADISON)



- 0+00 EXIST. TMI HH
- 0+06 EDGE WOODS
- 0+50 EDGE WOODS
- 0+86 EDGE DRIVE
- 1+06 EDGE DRIVE
- 1+20 CABLE PI

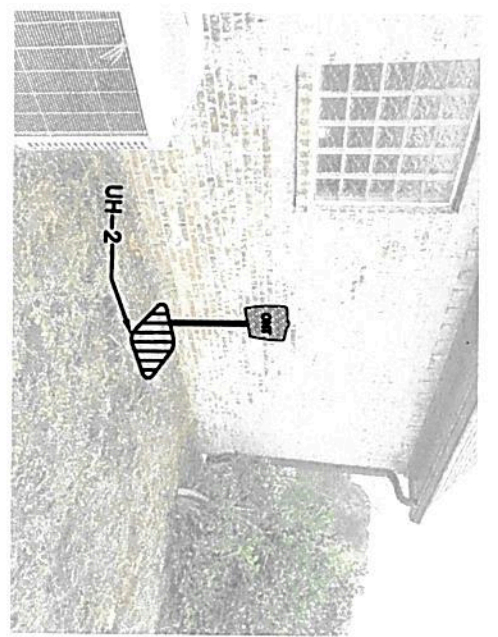

0+00-3+48  
DIRECTIONAL BORE 348'  
48" MINIMUM DEPTH  
(2) 1.25" HDPE  
PULL CABLE 348'  
(1) 12 CT. F.O.C.

0+00 PLACE 50' SLACK COIL  
OF 12 CT F.O.C.

3+48 PLACE UH-2 HANDHOLE  
E/W (1) 12 CT F.O.C.  
PLACE 50' SLACK  
PLACE 8' GND. ROD

3+48 PLACE 10' SLACK COIL  
OF 12 CT F.O.C.  
ON TOP OF ONT

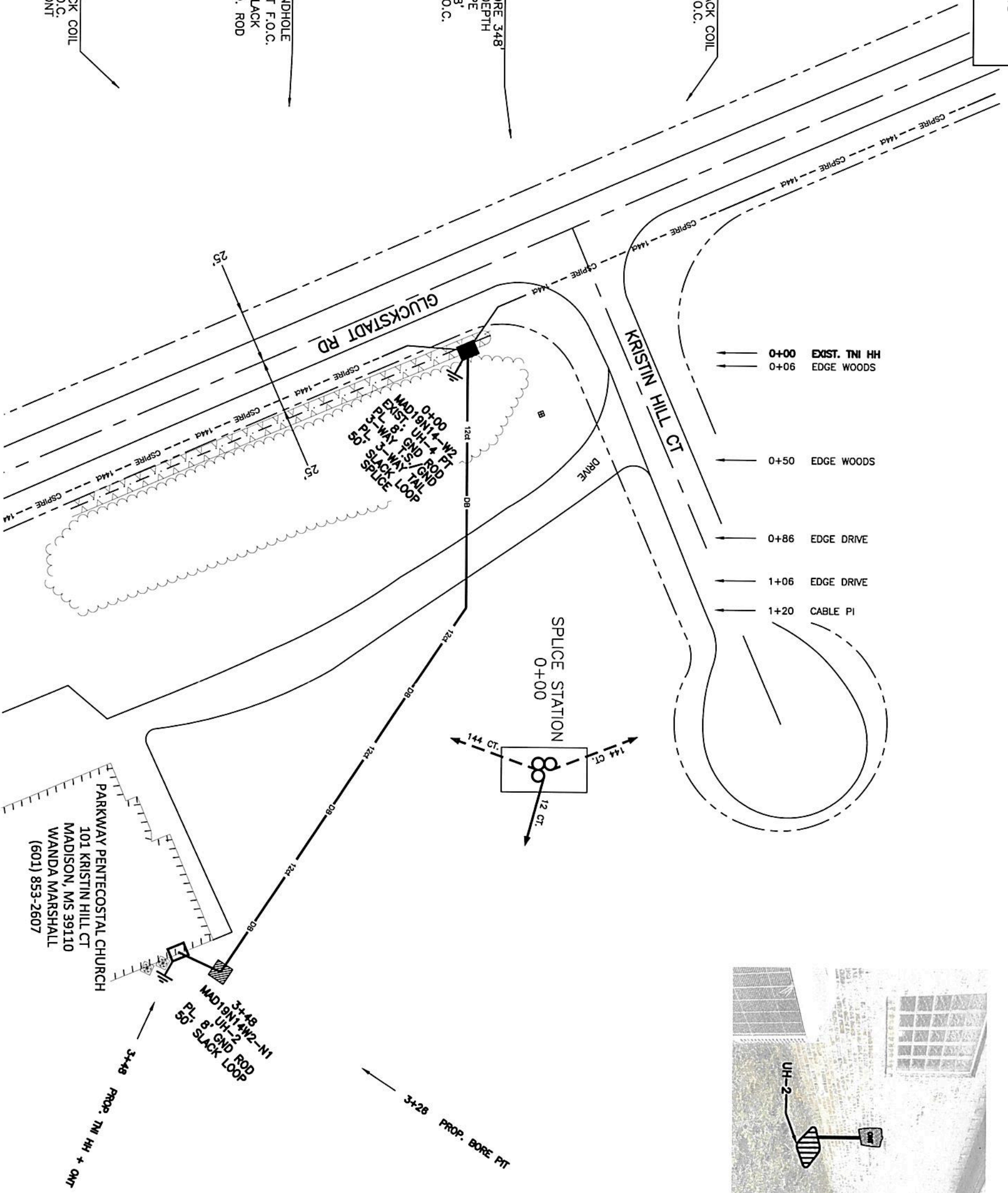

MAD1911-4-W2  
UH-2  
PL 8' GND ROD  
50' SLACK LOOP  
12 CT F.O.C.

PARKWAY PENTECOSTAL CHURCH  
101 KRISTIN HILL CT  
MADISON, MS 39110  
WANDA MARSHALL  
(601) 853-2607

3+48  
MAD1911-4-W2-N1  
PL 8' GND ROD  
50' SLACK LOOP

3+48 PROP. TMI HH \* ONT

3+28 PROP. BORE PIT

FILE NAME: Parkway Pentecostal Church (Underlay)  
PROJECT CITY: MADISON

DATE	DESCRIPTION
1/19/21	Construction

SHEET 001 SCALE 1"=50'

REV.	DESCRIPTION	INITIALS	DATE

ITEM	DESCRIPTION	QUANTITY
1	TOTAL CABLE FT.	458'
2	DIR-BORE CABLE	348'
3	PULL CABLE	0'
4	BURIED SLACK	110'
5	1.25" HDPE	696'
6	5" HDPE CASING	0'
7	HANDHOLES	1
8	MANHOLES	0
9	SPLICE CLOSURE	1
10	H-POSTS	0
11	GROUND RODS	2
12	AERIAL CABLE	0
13	RISERS	0
14		

PREPARED BY

43 Town Center Square, Suite 203  
Hattiesburg, MS 39402  
Office phone: (601) 402-9149  
Email: designservices@bbgelectrical.com

PREPARED FOR

NOTIFY ALL UTILITIES 72 HOURS PRIOR TO CONSTRUCTION ACTIVITY.  
ONE CALL SYSTEM ☎ 1-800-227-6477

DISCLAIMER

EXCEPT AS MAY BE OTHERWISE PROVIDED BY CONTRACT, THESE DRAWINGS AND SPECIFICATIONS SHALL REMAIN THE PROPERTY OF CSPIRE FIBER. NO PART OF THESE DRAWINGS OR SPECIFICATIONS SHALL BE REPRODUCED, COPIED, OR USED FOR ANY PURPOSE WITHOUT SPECIFIC WRITTEN PERMISSION.